

MX 15

Single Channel Controller

- On-board display
- DIN rail mounting provided
- Control up to 5 detectors
- 2 fully programmable alarms
- 3 on-board relays

Designed for use in boiler rooms and parking garages, the new MX 15 controller provides the most cost effective solution for the continuous monitoring of toxic or flammable gases and vapors in ambient air.

Easy to install and operate, the MX 15 control unit combined with the OLC(T) 10 detectors provide a low cost solution for light industrial applications.



ENCLOSURE

Size (W x H x D):	185 x 157 x 67 mm
Material:	ABS
Mounting:	By DIN Rail supplied
Cable entries:	3 cable-glands M20 (outer diameter 5.5 to 12 mm) 1 cable-glands M16 (outer diameter 4 to 8 mm)
Protection:	IP31

POWER SUPPLY

Voltage:	230 or 115 VAC and 21 to 30 VDC (nominal 24 VDC)
Consumption:	20 VA

OPERATING TEMPERATURE: -10 to + 45°C

CABLING

Sensors:	1 flammable gas detector OLC10 or 2 detectors OLC10 TWIN for detection of methane, butane, propane in boiler rooms and LPG, Natural Gas for Vehicles 1 flammable gas transmitter OLC10 for detection of methane, butane, propane in boiler rooms and LPG, Natural Gas for Vehicles 1 to 5 similar detectors type OLC10 for detection of CO, NO, NO ₂ in parking garages for example
Terminal block:	1 : signal I out / 2 : 0 V / 3 : + 24 VDC
Maximum cable length:	OLC10 (flammable only): 3-wire, shielded, core size 1 to 1.5 mm ² , 300 m max OLC10 TWIN (flammable only): 4-wire, shielded, core size 1 to 1.5 mm ² , 300 m max OLCT10 (flammable): 3-wire, shielded, core size 1 to 1.5 mm ² , 1 Km max OLCT10 (toxic): 2-wire, shielded, core size 0.75 to 1.5 mm ² , 4 Km max

DISPLAY

Type:	Liquid Crystal Display, 4 digits and user-friendly symbols
Visual indications:	4 LEDs. Green: power on, Red: alarms triggered, Orange: failure

Gas and unit: Selectable from a preprogrammed list

KEYBOARD:

3 keys for access to main menu, test or acknowledgement
1 : Enter / Menu, 2 : - / test indicator, 3 : + / acknowledgement

ALARMS & RELAYS:

2 programmable and independent levels, decreasing or increasing alarms, latching or unlatching modes, local or remote acknowledgment
2 alarm relays normally energized, selectable normally open or normally closed (de-energized on request at the factory)
1 fault relay, normally energized
Relay ratings : 2A at 250 Volts AC or 30 Volts DC

APPROVALS

ATEX 94/9/CE Directive:	Category 3G (flammable gas detection metrology EN 61779-1 and EN 61779-4)
Low Voltage Directive:	EN 61010
Electromagnetic compatibility (EEC directive):	EN 50270

**INDUSTRIAL
SCIENTIFIC**

www.indsci.com

MX 15

SPECIFICATIONS

Dimensions

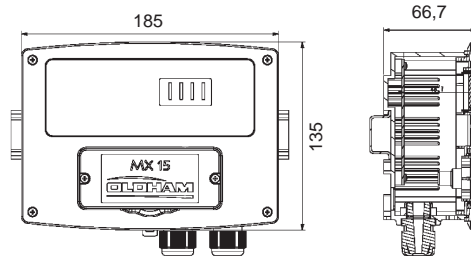

Wiring connection between OLCT 10 (toxic) and MX 15 control unit

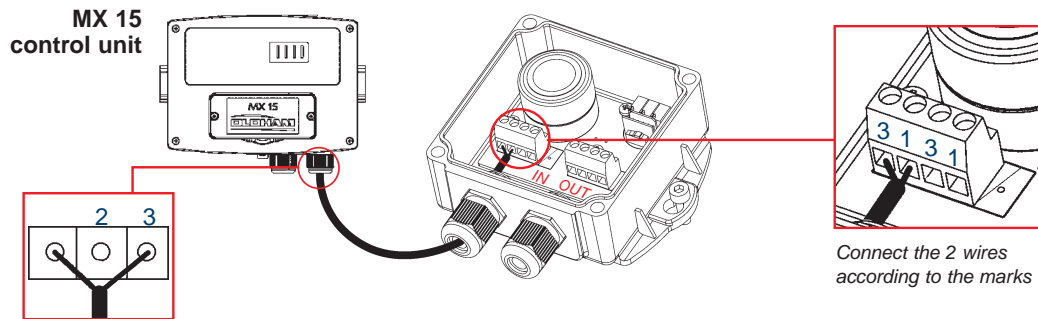

Example of wiring connection for combustible gases

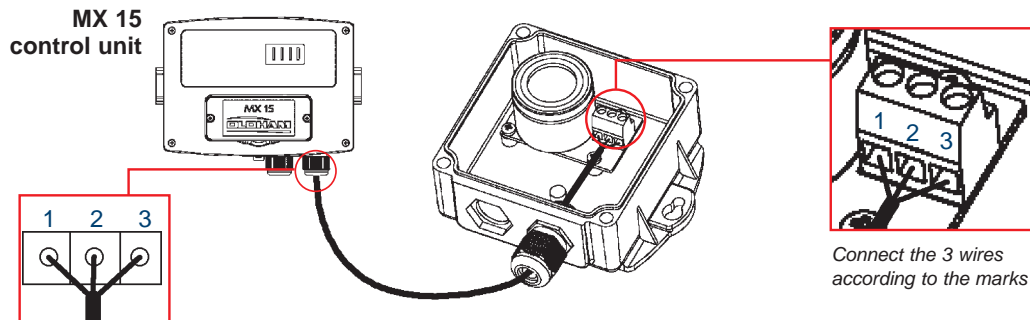

INDUSTRIAL SCIENTIFIC CORPORATION

CORPORATE HEADQUARTERS

1001 Oakdale Road • Oakdale, PA • 15071-1500 • USA

www.indsci.com



AMERICAS

Tel.: +1-412-788-4353

Fax: +1-412-788-8353

info@indsci.com

ASIA PACIFIC

Tel.: 86-10-8497-3970

Fax: 86-10-8497-3971

sales@isc-cn.com

EUROPE

Tel.: 33-3-21-60-80-80

Fax: 33-3-21-60-80-00

info@groupoldham.com

AUSTRALIA / NZ

Tel.: +61-2-8870-3400

GERMANY

Tel.: +49-231 / 9241-0

MIDDLE EAST

Tel.: +971-50-455-8518

SINGAPORE

Tel.: +65-6561-7377

UNITED KINGDOM

Tel.: +44-0-1782-562002

CZECH REPUBLIC

Tel.: +420-234-622-222/3

ITALY

Tel.: +39-011-3801371

NETHERLANDS

Tel.: +31-76-5427-609

SWITZERLAND

Tel.: +41-26-652-51-18